



Crocodile Expanding Waterstop (WATERSTOP-RX)

PRODUCT DESCRIPTION

Crocodile Waterstop-RX is a flexible strip concrete construction joint waterstop that provides a positive seal by expanding upon contact with water.

Crocodile Waterstop-RX is an active waterstop that functionally replaces conventional passive PVC dumbbell waterstops. It is designed for both continuous and intermittent hydrostatic conditions and has been successfully tested to resist 231 feet (70 m) of hydrostatic pressure.

The key to the effectiveness of **Crocodile Waterstop-RX** is its 75% sodium bentonite content which provides superior expansion to seal cracks and fill small voids. Proven effective on projects worldwide for over 20 years, It is a reliable and cost-effective solution to preventing water infiltration through concrete joints.

Crocodile Waterstop-RX is certified by NSF International to conform with the requirements of NSF Standard 61 - Drinking Water System Components - Health Effects, thus certifying that the product can be used in potable water storage structures.

Installation is fast and easy. Simply adhere **Crocodile Waterstop-RX** to the concrete, steel, or PVC (pipes) with WB-Adhesive and then pour the concrete. **Crocodile Waterstop-RX** reduces labor costs by eliminating the workmanship rigors of welding the joints or split-forming associated with traditional PVC dumbbell type waterstops. It can also be used to provide protection when conventional PVC waterstop has been installed without the joints welded.

Crocodile Waterstop-RX offers a low cost opportunity to enhance the performance of a sound external waterproofing system, by sealing the areas of highest probability of water infiltration through the concrete, and should therefore be implemented as part of the waterproofing design.



APPLICATIONS

- Construction joints in foundation slabs or below grade walls.
- Around pipes, steel H-piles, and other penetrations.
- New-to-existing concrete work.
- Septic tanks, sanitary and storm sewer manholes.
- Utility and burial vaults.
- Box culverts.
- Potable water tanks.

Technical Data:

| | |
|------------------------------------|---|
| Material | : 70% Sodium Bentonite + 25% Butyl Rubber |
| Color | : Black |
| Hydrostatic head resistance | : 231 ft (70 bar) |
| Wet/Dry Cycling (25 cycles @231 ft | : No Effect |

Sizes and packaging:

A rectangular cross section of 1" by 3/4" (25 x 19 mm). design for vertical and horizontal reinforce concrete 8" (20 cm) thick or greater with 2 rows reinforcing steel, minimum of 3,000 psi. It's required 3" (7.6 cm) minimum concrete coverage. Crocodile Waterstop-RX is not a self adhesive product. A WB Adhesive is required to secure it to metal or

Crocodile Expanding Waterstop WATERSTOP-RX



Cera C-Cure Co.,Ltd.

www.cera.co.th

102 Soi Rama IX 43 (Seri 4) Suanluang, Suanluang, Bangkok 10250 Tel: (662)0-2720-1000 (Auto) Fax: (662)0-2720-1386-7



Crocodile Expanding Waterstop (WATERSTOP-RX)

pvc pipe surface. Mechanical fastener should be use to secure waterstop in conjunction with adhesive on concrete surface concrete. Length per roll is 5.06 m and contain 6 rolls per box (total length per box = 100 ft or 30.4 m)

Waterstop-RX Advantages Over PVC Dumbbell Waterstops

- **Easy to Install** - Crocodile Waterstop-RX can be installed by one person without split-forming or splice welding roll ends.
- **Positive Seal** -Crocodile Waterstop-RX swells and forms a positive seal.
- **No Special Transition Parts** - Crocodile Waterstop-RX does not require special cross, corner, or "L" parts to transition from horizontal to vertical.
- **Safe** - Crocodile Waterstop-RX is non-toxic and requires no special handling.
- **Flexible** - Crocodile Waterstop-RX has excellent flexibility so it can be installed around irregular penetrations like steel H-Piles.
- **NSF Standard 61 Certified** - Use with potable water tanks
- **New-to-existing Concrete** - Installs without chipping or saw-cutting existing concrete

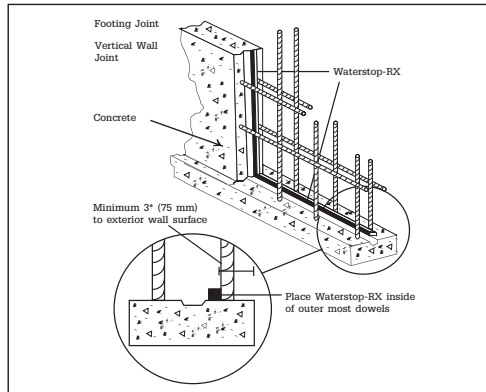
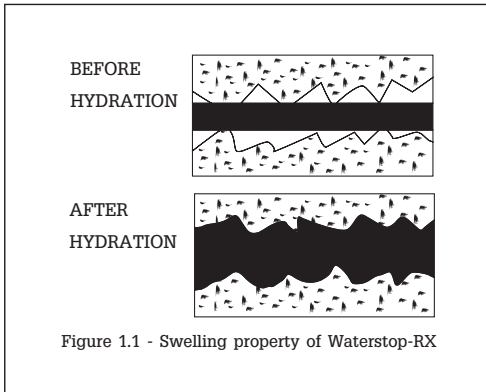

FOOTING AND WALL JOINTS



AROUND PIPES



SLAB EDGES



STRUCTURAL PENETRATIONS

CAUTION

- Do not expose to the rain or water before 2 hours of application
- Not recommended for horizontal application where water may immerse or below grade applications

KEEP OUT OF REACH OF CHILDREN.

PACKAGING

25 mm x 19 mm cartridge fills long for 5.06 m Item No.

1 year from date of manufacture if stored in unopened original packing in dry, frost-free conditions.



Cera C-Cure Co.,Ltd.

102 Soi Rama IX 43 (Seri 4) Suanluang, Suanluang, Bangkok 10250 Tel: (662)0-2720-1000 (Auto) Fax: (662)0-2720-1386-7

www.cera.co.th

Crocodile Expanding Waterstop WATERSTOP-RX

CROCODILE